

A PLUSH HOME THAT'S  
ALSO AFFORDABLE



G + 6 APARTMENTS AT JALUKBARI, GUWAHATI



# ENVIRONMENT-FRIENDLY ARCHITECTURE WITHIN YOUR BUDGET



From the finest of nature to the refined in luxury, if you can imagine it-it is here.

The elegant elevation in the locale. And the highest in lifestyle!

**Marigold Parks**, located at **Jalukbari** - the upcoming centre of buzz in **Guwahati** !



**MARIGOLD  
PARKS**  
GUWAHATI





AERIAL VIEW

## BALANCE OF STRONG SECURITY & EASY LIFESTYLE

Marigold Parks offers you a great balance between a robust security setup and best-in-class amenities that doesn't strain your finances. Get the lifestyle you always cherished, at the choicest of prices.



Well-trained & polite but firm security personnel



Advanced fire-fighting equipment from renowned suppliers



Open Space With Beautiful Landscaping



Community Hall & Gym with standard equipment



Optimally positioned CCTV cameras for live surveillance

Video door security provides advanced security right up to your door



Intercom lines to every apartment for seamless communication with maintenance and security service personnel





# SYNTHESIS OF ELEGANCE & SIMPLICITY

Marvel at the optimization of minimalist and maximalist elements in Marigold Park's elevation



Night View



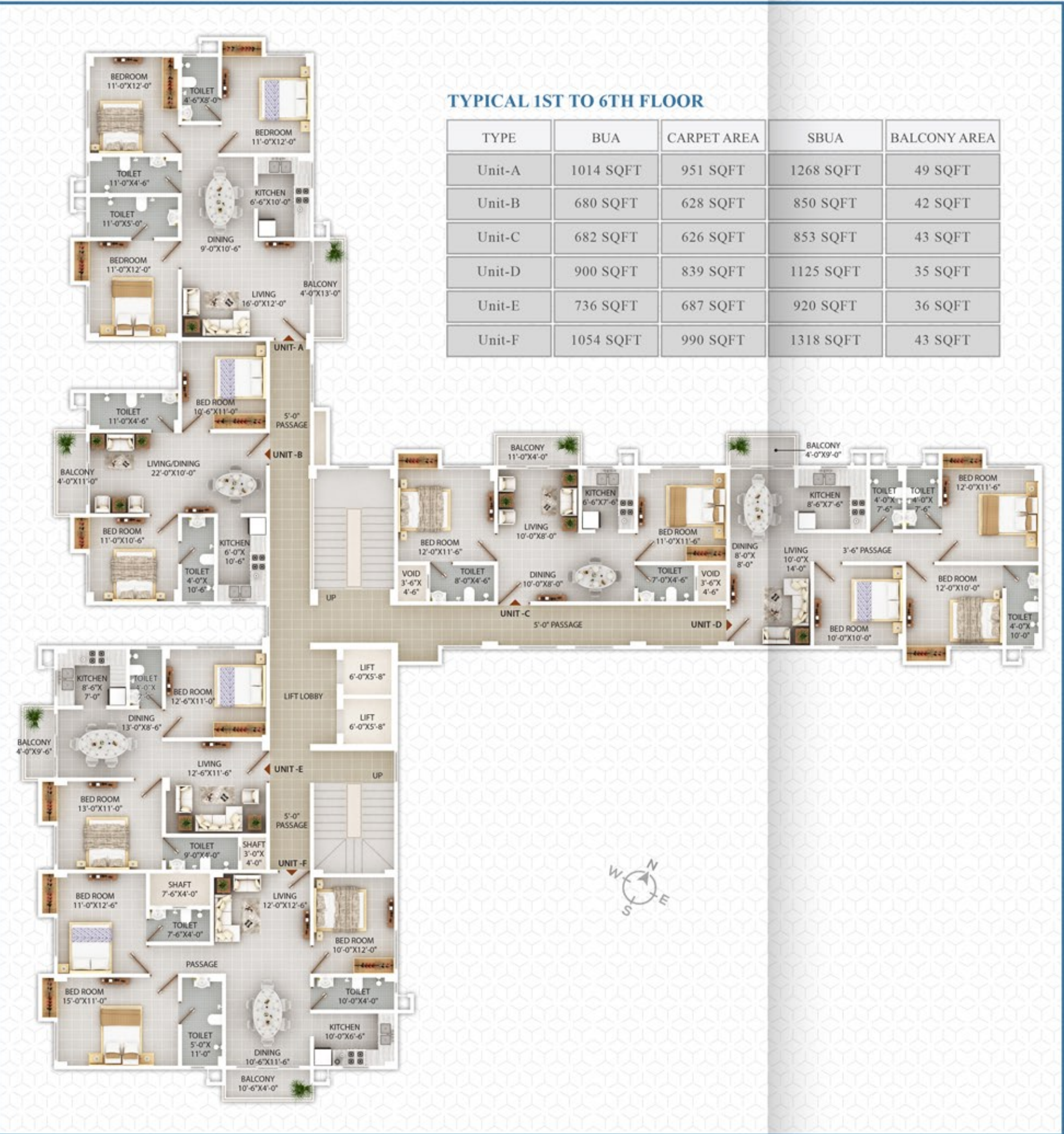

FLOOR  
PLAN





ALTOGETHER DIFFERENT LEVEL OF  
QUALITY THAT FITS YOUR BUDGET



**SUPER STRUCTURE**



RCC Frames Structure with pile foundation



**FLOORING**

Vitrified tiles in the Bedrooms, Living Room / Dinning Room



**KITCHEN**

Kitchen will be designed to suit Moduler / Semi Moduler kitchen

Extra Plumbing point for Water Purifier

Electrical point for Water purifier

Exhaust Point / Chimney Point

Flooring : Anti-skid ceramic tiles



**WALL FINISH**

Putty Finish on Walls



**TOILET**

Flooring : Anti-skid Ceramic tiles

Walls : Ceramic tiles

Sanitary ware of Cerra, Parryware or equivalent

CP fitting of reputed make

Electric point for Exhaust fan & Geyser

Plumbing Provisioin Hot / Cold water line



**ELEVATORS**

2 Nos Modern High Speed Manual Elevators of KONE /OTIS/ THYSSENKRUPP or Equivelent make



**OTHERS**

Overhead illumination for compound and street lighting. Necessary illumination in all lobbies, staircase & common areas.

Well designed common lobbies. 100% Power back-up for common area facilities.

Intercom facility in each unit. CCTV surveillance in common areas.

Modern Fire-fighting system. Electric point for Air Conditioner in all bedrooms.

24 hours Water supply.

**DOORS & WINDOWS**



Door Frame made of Wood

Main Door : Polished solid core Flush Doors

Main door with reputed make fitting with Eyepiece

Internal doors : Laminated Flush doors with stainless steel fittings

Branded hardware fitting and lock of reputed make

Powder Coated alluminium Window frames With sliding windows



**ELECTRICAL**

Concealed Copper wiring of Havels, RR or equivalent

Telephone / Internet wiring in Master Bedroom

Moduler switches of reputed make

DTH / Cable TV cabling in Living room & Master Bedroom



**ONGOING PROJECT**

**LUIT VIEW,**

F.A. Road,  
Opp. Rosebud  
English School,  
Machkhowa,  
Guwahati.





**KEY DISTANCES**

- Kamakhya Station - 1.8 Kms
- Maligaon Hospital - 1.5 Kms
- Assam Engineering College - 2.5 Kms
- Jalukbari Circle - 1.2 Kms
- Petrol Pump - 1.3 Kms
- Gauhati University - 2.0 Kms
- Airport - 15 Kms

**THE NEW LANDMARK  
IN GUWAHATI.**

**PROMOTERS**



2nd Floor, Garima Royal, Danish Road, Panbazar  
Guwahati - 781001  
Mob: +91 98640 29001 Tel: 0361 2974417  
info@nativetree.co.in  
www.nativetree.co.in

**SITE ADDRESS**

Pragjyotish Nagar Path,  
Jalukbari,  
Guwahati-11

**ARCHITECTS**

Banka & Associates

Note : All details in this booklet are for easy information and concept purposes only, and do not form part of the agreement. This document is tentative and developers reserve the right to make variations and modifications.